

# WINEMASTER

le temps d'être différent

## WINEMASTER CONNECT

Thanks to WineMaster Connect, you can remotely adjust the settings and ensure that your air conditioner is working properly.

Simply plug our connected box into your air conditioner to monitor or modify the main operating parameters in real time.

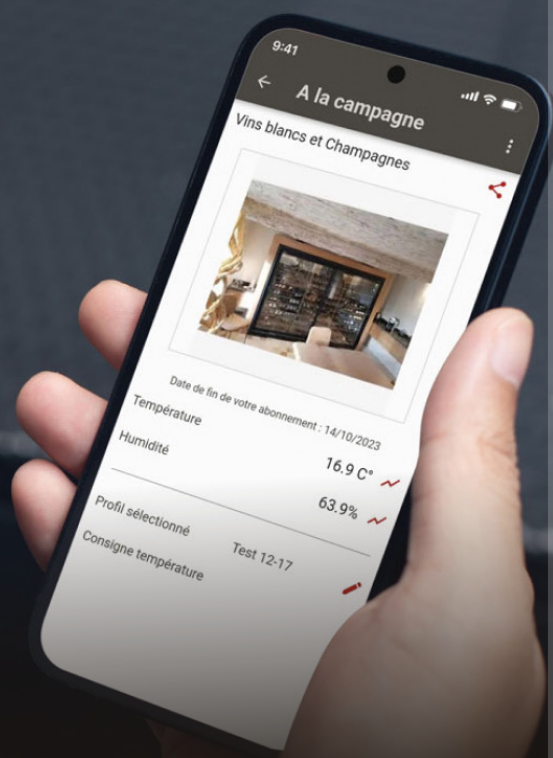

### THE BENEFITS OF WINEMASTER CONNECT



Optimal wine conservation



Remote supervision

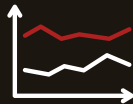

Statistics in real time



Failure alerts



Available on Google play & App store

### JUST ONE BOX AND YOU'RE CONNECTED!

With WineMaster Connect, monitoring your wine cellar has never been easier! Simply plug our connected box into your air conditioner and benefit from real-time monitoring of your wine cellar.



# WINEMASTER CONNECT

YOUR CONNECTED WINE CELLAR



# WINEMASTER CONNECT

## Optimise the conservation of your wine

Optimise the storage of your wines with the WineMaster Connect application. Follow the temperature and humidity levels in your wine cellar and be alerted if there are any abnormal variations. You can define several profiles with different settings according to the conservation needs of your wines. Finally, you can share your wine cellar's technical data with your friends and family, so that they can keep an eye on it.

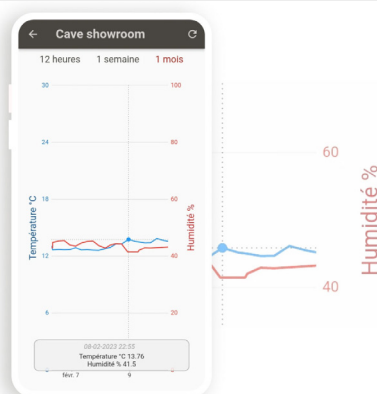
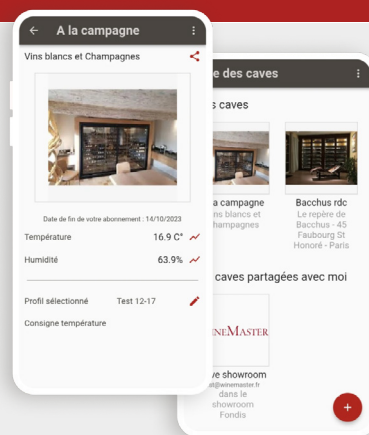

## Statistics in real-time

Keep track of your wine cellar statistics in real time. From the application, you can display a graph showing variations in temperature and humidity over time over 12 hours, 1 week or 1 month. So you can easily see your wine cellar's parameters and detect any abnormal variations.

## Remote control

With WineMaster Connect, you can benefit from remote supervision in the event of an incident or breakdown. If necessary, you can contact your installer, who will be able to supervise your wine cellar remotely. To do this the installer will provide you with his email address, which you will need to enter in the application to authorise him to supervise your wine cellar. The installer will be able to monitor the parameters and intervene to solve the problem.

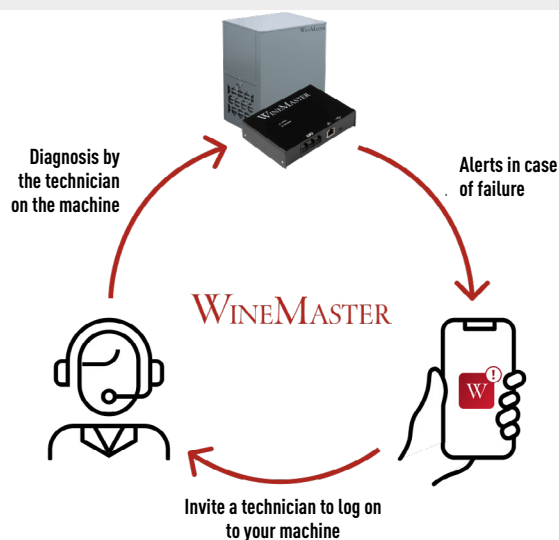
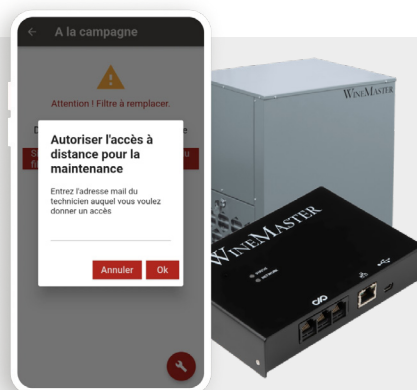

## Be warned to react better in the event of a breakdown

You'll be warned in real time if your wine cellar breaks down or malfunctions. Thanks to the box connected to the air conditioner, you can measure the parameters of your wine cellar and receive an immediate alert in the event of a breakdown. If technical intervention is required, you can invite your installer to connect to your machine to diagnose the problem. Thanks to this feature,

**Prerequisites:** To use the WineMaster Connect service, you need to install the connection box, which you can order with the air conditioner or at a later date.

## How do I activate it?

1. Download the WineMaster Connect application for tablets or smartphones from the AppStore (Apple) or PlayStore (Android).
2. Create your WineMaster account from the application.
3. Link your appliance by scanning the QR Code placed on the air conditioner.
4. Once your subscription has been activated\*, you're connected! \*

\*Annual subscription of €90 incl. VAT, payable online via the WineMaster Connect application or on [www.winemaster.fr/en](http://www.winemaster.fr/en).

# WINEMASTER

FABRICANT FRANÇAIS DE CLIMATISEURS DE CAVES À VINS

■ Z.I. VIEUX-THANN - 18 RUE GUY DE PLACE  
BP 60010 - F68801 THANN CEDEX  
■ Tél : +33 (0) 389 377 515  
■ E-mail : [contact@winemaster.fr](mailto:contact@winemaster.fr)  
[www.winemaster.fr](http://www.winemaster.fr)